

Safety Reminders / Adverse Conditions

WZS: Remember "Your Circle of Safety"
 WZS: TRAFFIC FLAGGING
 WZS:
 WZS:
 WZS:



USP: NEAREST USP DEVICE IS 100T FUSED CUTOUT ON POLE
 USP: 20G-722E LOCATED AT FERGUSON BLVD & HWY 22
 USP: NEXT USP DEVICE IS STATION BREAKER
 USP:
 USP:

Safety Circle of Safety

PERSONAL ACCOUNTABILITY
 ACTIVE CARING
 HAZARD RECOGNITION

REMEMBER: Work zone area conditions may have changed for this job! Everyone is responsible for verifying the above safety information is correct prior to any work being performed each day.

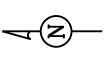

CONSTRUCTION SCHEDULE:
 NO STANDING ORDERS
 OH CONSTRUCTION: 92.31
 TRAFFIC FLAGGING: 16
 TOTAL LABOR HRS: 108.31
 LBO# 134983

* NOTE: WORK WITH EMAX # 10121792

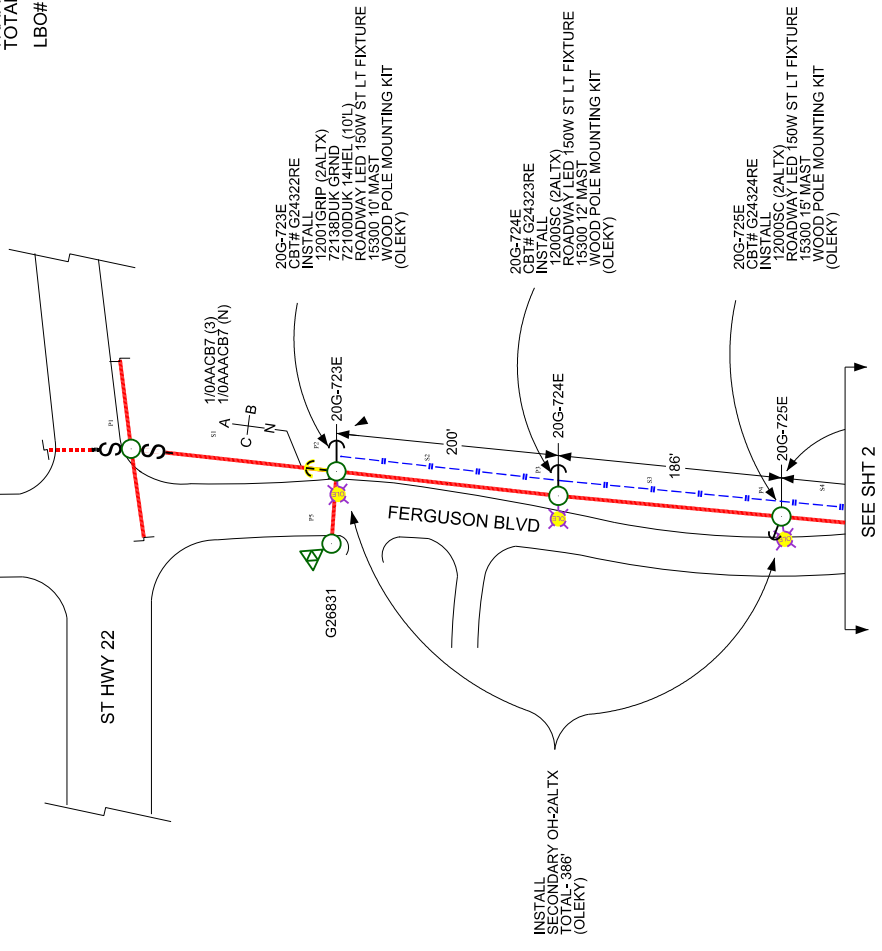

Approval Date	
Project ID(s)	OLEKY
Transmission Circuit	
Substation Circuit	GRANT "41"
URD Number	
Primary Voltage	7.212.4KV
District	ERLANGER
Responsibility Center	SA71
Location	V832
Tax Code	06800010800
Total Labor Hours	108.31
Foreign Cable #	
Right of Way	Yes No X
Tree Trimming	Yes No X
Facility Agreement	Yes No X
Permit Required	Yes No X
Permit Type/No.	
Permit Type/No. 2	
Permit Type/No. 3	
Permit Type/No. 4	
Completed By	
Completed Date	

Work Order Number	10093346
Customer/Contact	CITY OF DRY RIDGE/JIM WELLS
Contact Phone	859.824.3935
Job Site Address	FERGUSON BLVD
City	DRY RIDGE
County	GRANT
State, Zip	KY, 41035
Designer	Joseph Groeschel
Designer Phone	859-534-4356
INSTALL 14-150W LED LIGHTS & #2ALTX SECONDARY ON EXISTING POLES	

DUKE ENERGY

Sheet 1 of 2
 Scale = N/A